

Dicer

Art. Nr. 327/008

Caution



Be careful, this device is equipped with blades. Keep out of children's reach. Before first use, it is recommended to wash the device in hot water.

How to use



Before and during each use, make sure the device is in good condition. Each defective part must absolutely and immediately be replaced with original part by authorized personnel.

Put the device at a suitable height and on an unoccupied surface, stable and flat.

1) Bring the pusher on high position by lifting the lever up (picture 1).

2) Put the slices, previously cutted, flat on the cutter blade (picture 2).



Be careful to the very sharp cutter blade!
Do not put a hand between the pusher and the blade
While using the device!



3) Firmly take down the pusher, by pressing on the lever, to obtain a perfect cut (picture 3).

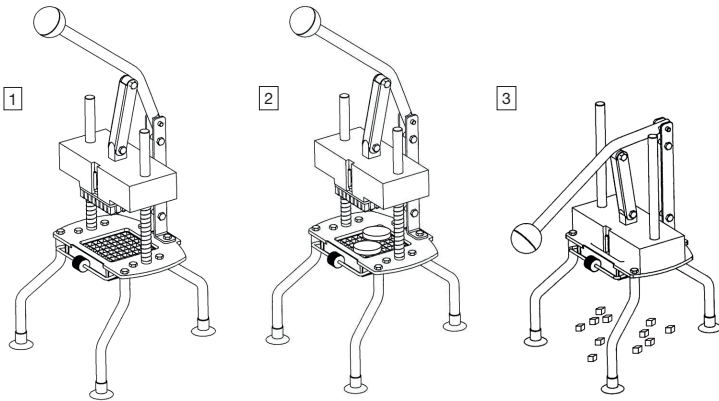

To get 8 or 10 mm cubes, it is very important to prepare slices of 8 or 10 mm thickness.

Cleaning

The device can be cleaned using a moist cloth or a sponge. It can be putted in dishwasher.

Assembly and desassembly of the blades and pushers

Cutter blade

Drive the cutter blade, cutting edge up, in the runner. The sill of the cutter blade must be on the top and get stopped by the buttress in the compartment.

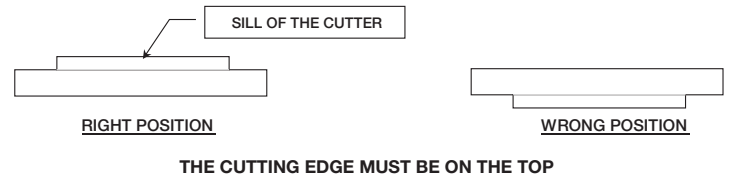

Tighten the cutting blade using the holding spring.



Be careful and make sure that the holding spring is well placed on the cutter blade! The holding spring must be placed as shown on the picture, in horizontal position. In this position, the cutting blade is effectively maintained and the pusher can't damage the cutter blades.

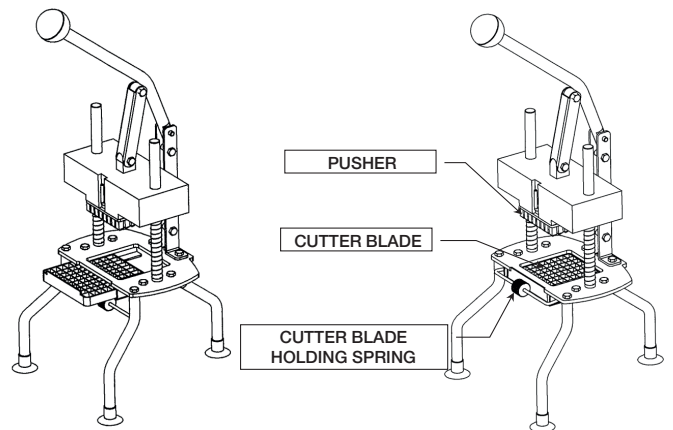

Pusher

Slot the pusher's picks in the hole located in the slider. Tighten the pusher using the pin.